



Delmarva Pump Center, Inc. / DBA
DPC Emergency Equipment
www.dpcemergency.com

335 Strauss Avenue
Marydel, DE 19964
Phone: (302) 492-1245
Fax: (302) 492-1340

526 Crown Stone Road
Marydel, MD 21649
Phone: (410) 482-6474

FOR IMMEDIATE RELEASE

MARYDEL, Delaware – August 7, 2013 - The Solomons Volunteer Rescue Squad & Fire Department in Calvert County, Maryland has purchased a new PL Custom ambulance from DPC Emergency Equipment. The new Ambulance 38 will be built on 2014 Freightliner M2 chassis and will replace a 2006 Horton.

Ambulance 38

- 2014 Freightliner M2 chassis
- Sigtronics vehicle intercom system
- PL Custom Titan 170” body
- PL Custom sliding curbside entry door
- 75” interior headroom
- PL Custom “Medic in Mind” curbside layout
- Streetside squad bench
- 6” cutback on each side
- PL Custom/V-MUX Oxygen Monitoring System
- Weldon V-MUX multiplex electrical system
- Weldon Diamondback LED warning lights
- Weldon 8051 low profile LED dome lights
- Hansen LED compartment strip lights
- ROM Durolumen V3 LED ceiling lights
- Stryker Power-LOAD stretcher lift system
- Custom graphics package by PL Custom

A family owned and operated company, DPC Emergency Equipment has continuously served public safety personnel in Delaware and Maryland for 23 years. DPC is an authorized sales and service dealer for Rosenbauer, PL Custom, and Wheeled Coach in Delaware and Maryland. To learn more about our company, people, products and services, visit our website at www.dpcemergency.com.

Visit the Solomons Volunteer Rescue Squad & Fire Department online at: www.svrsfd.org

Visit PL Custom Emergency Vehicles online at www.plcustom.com.

EXTERIOR CONCEPT DRAWINGS

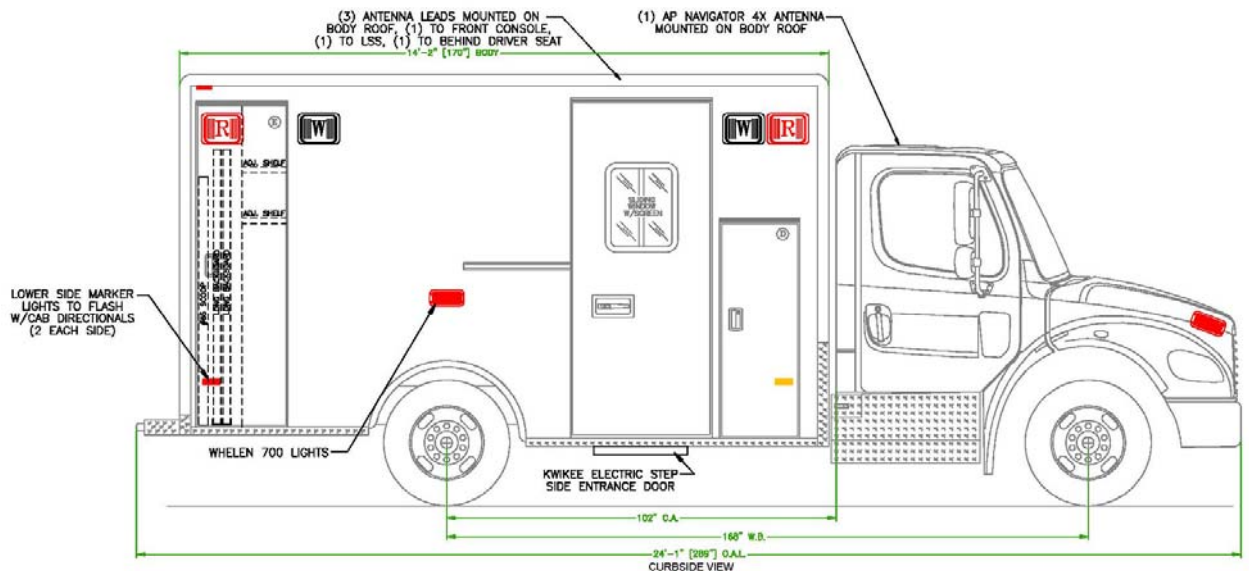
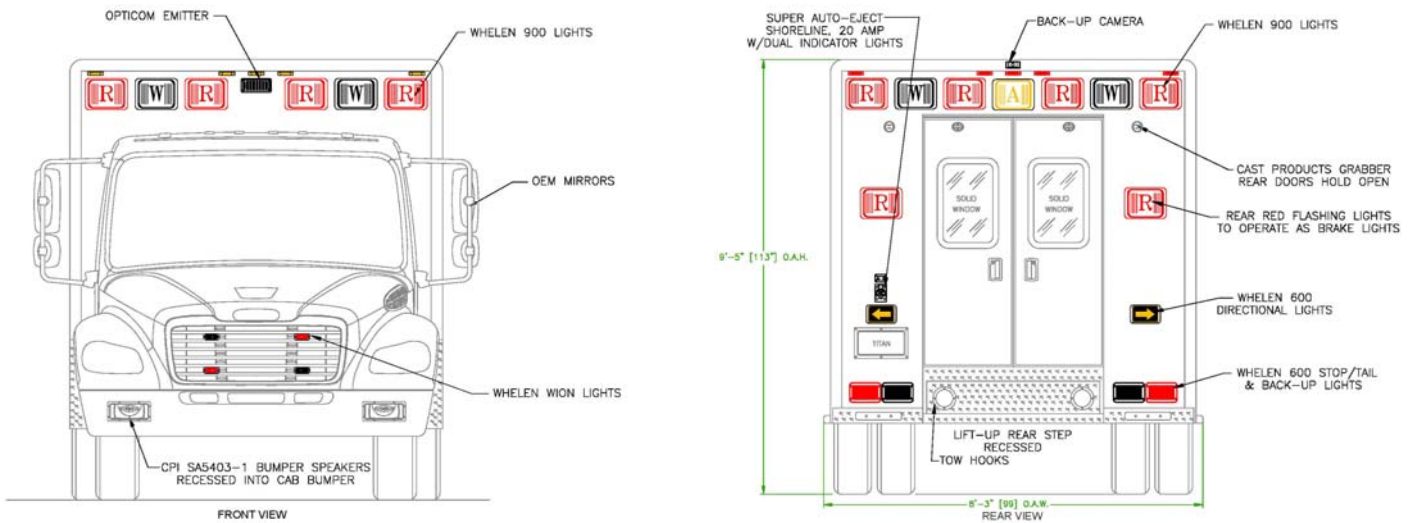
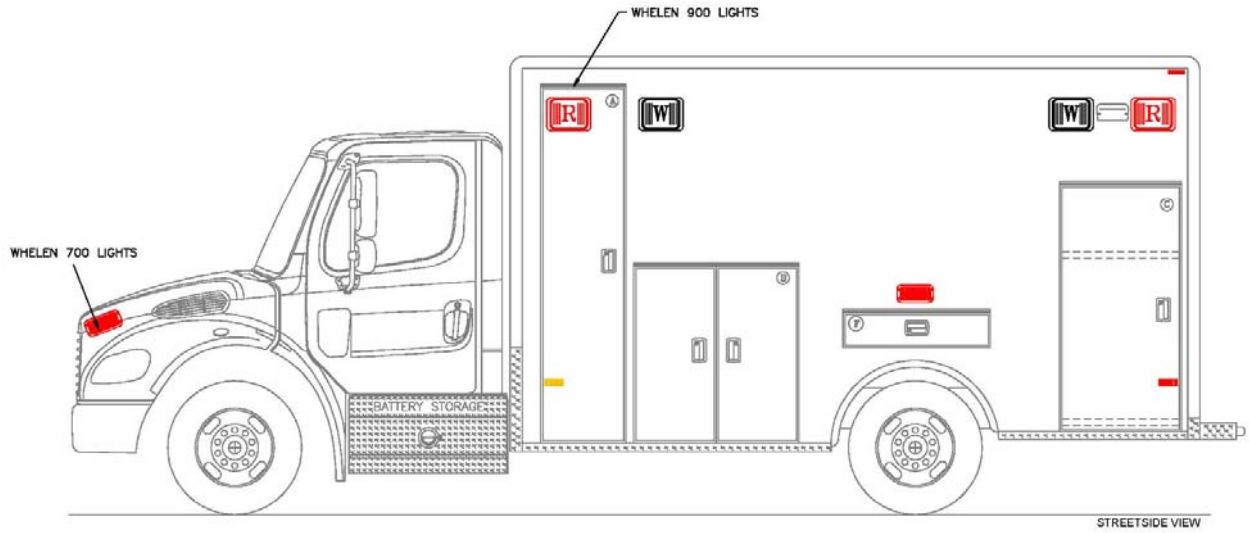

INTERIOR CONCEPT DRAWINGS

